

AD Building: Smith Conference



These classrooms contain:

- 1 Overhead Projector 3M 9100
- 1 Toa Audio Amplifier
- 1 Video Data Projector
- 1 Pull Down Video Projection Screen
- 1 VHS/DVD combo player
- 1 HP Compaq 6005 Computer
- 1 27 inch Sharp Television w/Cable
- 1 Sympodium Interactive Pen Display

Operating Class Room Media:

- 1) Open the cabinet located in the front of the classroom. Inside you will see a red on/off button. Go ahead and switch it to the on position.



- 2) All equipment in the cabinet should now be powered on. **If it's not, simply power on the VHS/DVD combo unit, Toa amplifier and computer individually.**



- 3) Now find the remote for the video data projector. Press the **on button** while pointing it towards the data projector located on the ceiling. It will take about 30 seconds for the projector to warm up. Press the **off button twice** to turn off data projector before leaving the classroom. The fan will continue to run allowing the bulb to cool off.



Selecting a Source to Display:

To select the display source for the projector, use the "remote" and press

Computer1, Computer 2

Video, S-Video (VHS/DVD)



- 4) Using your remote mouse:



1. Using your thumb, press anywhere on the edge of the pad to navigate the cursor around the screen.

2. Use the *primary* button (known as the "Click Trigger", located under the Remote unit) as a left mouse button.



It is important that the data projector and red switch are turned off before leaving the classroom.

Teaching with the Sympodium

- 5) Use the **stylus** attached to the SMART Sympodium to draw on the screen. Do not write on the SMART Sympodium screen with dry-erase markers or pens. Use the **Pen Tool** to select the ink color, eraser, or mouse cursor or use the floating tool menu.

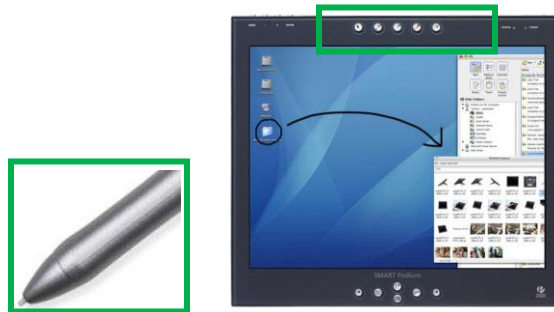

For more information or media assistance, contact:

Media Technology

Palm Beach State College 561.207.5815
3160 PGA Boulevard 561.207.5821 (Fax)
PBG, FL 33410

<http://www.palmbeachstate.edu/MTIS/troublereport.asp>



For computer issues contact the IT Help Desk at 561.868.3100

